

SAMWAL[®] PL

READY MIX POLYMER PLASTER

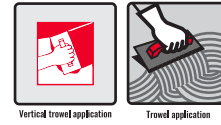

DESCRIPTION:

- SAMWAL PL is a ready-to-use dry powder requiring only the addition of water. It produces a high strength mortar with non-shrinking property. The material is a mixture of specially processed cement and carefully graded fine aggregates. Additives impart high water retaining properties and adhesion to substrate. The very low water / cement ratio ensures high early and ultimate strengths.

ADVANTAGES:

- It gives very high strength; nearly three times more than the normal mortar.
- Ensures effective bonding and eliminates shrinkage problems associated with conventional cement concrete / mortars.
- Provides a uniform micro-cellular material structure and smooth dust-free finish.
- No metallic iron content to corrode and cause staining or deterioration due to rust expansion.

METHOD OF USE:

- Clean the base by removing dust, loose particles grease, paint and traces of foreign materials.
- Dampen dry concrete / rendered surfaces where-ever necessary before application of SAMWAL PL.
- Add SAMWAL PL to mixing bucket containing clean potable water.
- Mix until an even homogenous mortar is obtained and keep the mixture as it is for 10 minutes for additives to dissolve.
- Mix again and paste is ready to use.
- Trowel firmly into all edges first and over the entire area.
- SAMWAL PL must be cured immediately as soon as the surface slightly stiffens for a minimum period of 72 hours.

RECOMMENDED APPLICATIONS:

- Plastering interior / exterior walls and ceiling.
- Patching and repairing of work areas.
- Filling of holes or depressions in concrete floor slabs of factories, godowns, commercial or domestic buildings etc.

PRODUCT DATA:

Form	Powder			
Base	Cement			
Colour	Grey			
Dosage / Consumption	8-9 litres water / 25kgs SAMWAL PL			
Mechanical properties	Materials Consistency	Temperature	Water / powder	Adhesion (N / mm²)
	Mortar Mix	27°C	0.32	0.5
Pot-life	2 Hours			
Shelf life	12 months at 25°C			
Safety	Non-toxic			
Caution	SAMWAL PL plaster should be stored in dry and closed place.			
Packing	25 kg bag (HDPE)			

CONSULT OUR PRODUCT APPLICATION DEPARTMENT (PAD) IN CASE OF ANY DIFFICULTY OR FOR TECHNICAL ASSISTANCE

SAMROCK products are guaranteed for the performance of material and manufacture. The details given here are based on our laboratory and field observations and as such as construed to be reliable. But we shall not accept responsibility for any work carried out with our material as we do not have control over other ingredients, workmanship and field conditions. This data sheet is subject to change in view of constant research and development being undertaken in our laboratories. Customers are advised to contact SAMROCK for the latest version.

SAMROCK CHEMICALS (i) LTD.

ISO No : 9001 Company | CIN No. : U24231GJ1991PLC015607

302, Chanakya Building, Near Dinesh Hall, Ashram Road, Ahmedabad, Gujarat - 380009

Call : +91 9825011576 | Email : info@samrockchem.com